

## NOMENCLATURE

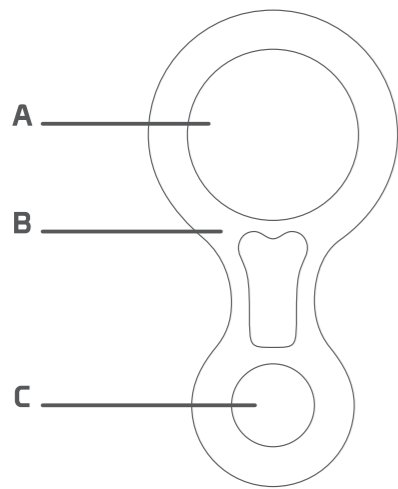

**A** Rope passage hole | **B** Body | **C** Attachment point  
**Main material:** aluminium alloy

**A** Foro di passaggio della corda | **B** Corpo | **C** Punto di attacco  
**Materiale principale:** lega di alluminio

**A** Trou de passage de la corde | **B** Corp | **C** Point d'attache  
**Matériau principal :** alliage d'aluminium

**A** Seildurchgangsloch | **B** Körper | **C** Befestigungspunkt  
**Hauptmaterial:** Aluminiumlegierung

**A** Agujero de paso de la cuerda | **B** Cuerpo | **C** Punto de fijación  
**Material principal:** aleación de aluminio



# 805.030 8 CLASSIC

WWW.KONG.IT



**Read and always follow the information supplied by the manufacturer**  
 Leggere e seguire sempre le informazioni fornite dal fabbricante  
 Toujours lire et suivre les informations fournies par le fabricant  
 Die Angaben des Herstellers müssen immer gelesen und befolgt werden  
 Lea siempre y respeta la información proporcionada por el fabricante



**Download the declaration of conformity at:**  
 Scarica la dichiarazione di conformità da:  
 Télécharger la déclaration de conformité sur:  
 Laden Sie die Konformitätserklärung herunter von:  
 Descargar la declaración de conformidad en:  
[www.kong.it/conformity](http://www.kong.it/conformity)



**Please calculate the lifespan of the device according to:**  
 Calcola la vita utile del dispositivo in accordo a:  
 Calculer la durée de vie de le dispositif selon:  
 Berechnen Sie die Lebensdauer der Vorrichtung nach:  
 Calcular la vida útil del dispositivo según:  
[www.kong.it/en/life/](http://www.kong.it/en/life/)

Y5685000BEK

KONG S.p.A. - Via XXV Aprile, 4 23804 Monte Marenzo (LC) - Italy  
 +39 0341 630506 | info@kong.it

## SPECIFIC INFORMATION

Master Text

The device 805.030 8 CLASSIC is:  
 - a manual braking device without function to adjust the friction, suitable for mountaineering, climbing and related activities for belaying and abseiling;  
 - suitable for use with:  
 • single ropes diameter range 9 - 13 mm,  
 • twin ropes diameter range 8 - 8,9 mm,  
 • half ropes diameter range 8 - 8,9 mm,  
 • static ropes diameter range 9 - 12 mm,  
 - compliant with EN 15151-2:2012 type 2 and UIAA 129 V9.

### Winding the rope

The rope/ropes must pass inside the hole (A) and wrap around the body (B). Twin and half ropes must not overlap (fig. 1).

### Device connection

Insert a connector into the attachment point (C) of the device and connect it to the belay loop of the sit harness (fig. 2).

### Descent

The descent speed can be controlled by gripping on the free end of the rope, and by varying the exit angle (fig. 3).  
 During descent use an additional locking feature, such as a friction hitch (e.g. prusik or machard) - (fig. 4).  
 Example of wrong and dangerous use: always control the free end of the rope (fig. 5).

### Belay anchor

Examples of correct use as a belaying device: for belaying the leader (fig. 6) or for belaying the second (fig. 7).

### Important:

- when using ropes conforming to EN 892, take into account the major elastic stretch;
- it is responsibility of the user to familiarize himself with the braking effect available before each use;
- when using this device, the system which this device is part of must always be stretched so as to limit any fall;
- the braking effect is dependent on the rope diameter, slipperiness of the rope, wet conditions, position of the hand controlling the free end, and other factors. Before using the device, a test in a safe position is recommended.

### Compatibility

- This device has been designed to be used with:
- connectors according to EN 362, EN 12275;
  - single ropes diameter range 9 - 13 mm conforming to EN 892;
  - twin ropes diameter range 8 - 8,9 mm conforming to EN 892;
  - half ropes diameter range 8 - 8,9 mm conforming to EN 892;
  - static ropes diameter range 9 - 12 mm conforming to EN 1891.

### Warning:

- the free end of the rope must be controlled by hand at all times (fig. 5);
- pay great attention when near the end of the rope: even with a knot, the rope may slip out of this device;
- performances may differ from what described in the standards if the device is used with ropes different from those specified in this information;
- particular conditions (e.g. heat, cold, wet, oil and dust etc.) can greatly limit the performance and operation of the device.

### Checks before and after use:

- Before and after use, make sure that the device is in an efficient condition and that it is working properly, in particular, check that:
- it is suitable for the intended use;
  - is free of cracks, corrosion, mechanical deformation and that any wear and tear is only of an aesthetic nature;
  - the rope passage area is free of any extraneous element (stones, sand, mud, lubricants, etc.);
  - markings are legible.

## DRAWINGS

1

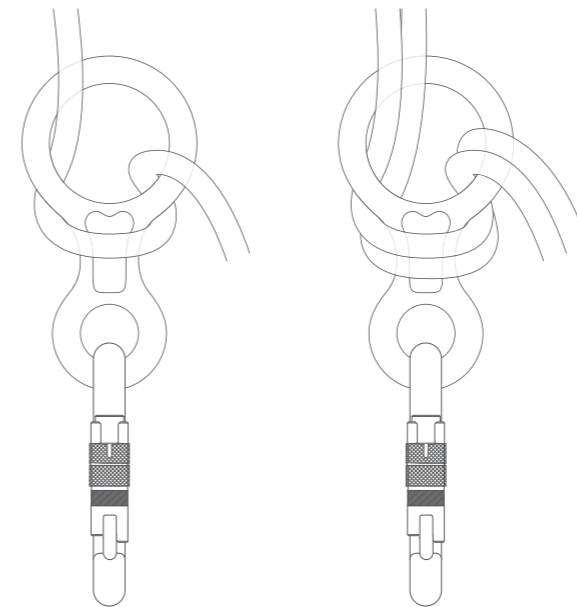

2

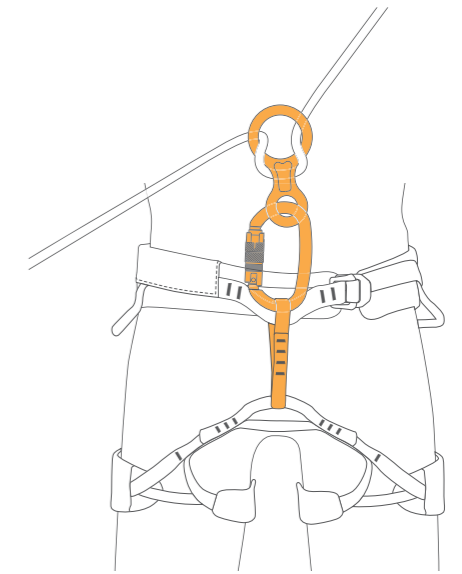

3

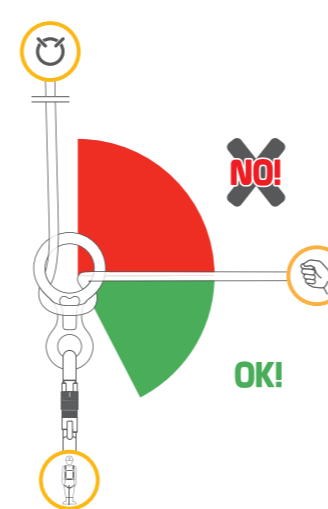

4

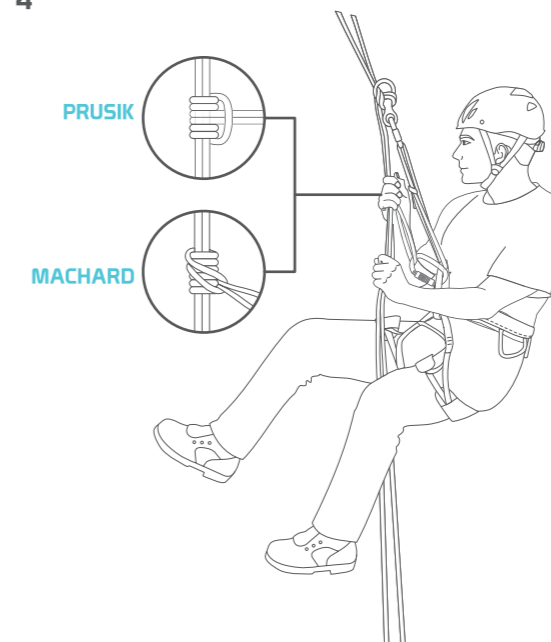

5

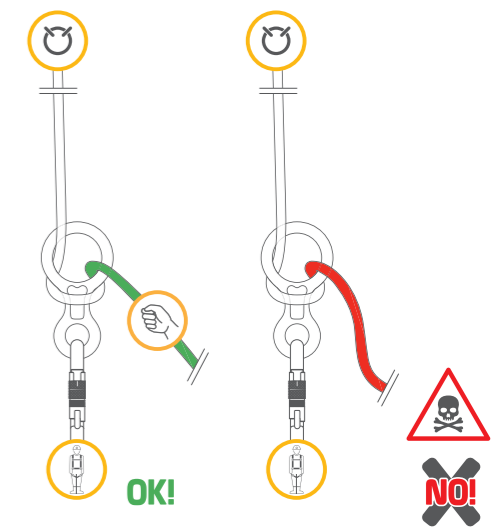

6

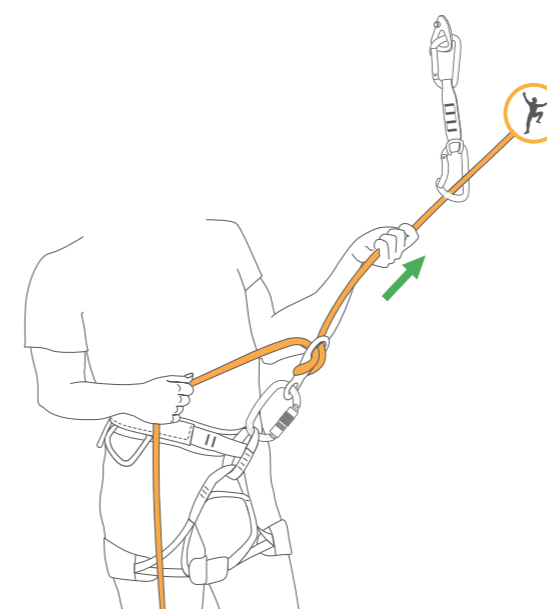

7

